



TRIBUTARY®



AN ELEGANTLY SIMPLE FARMSTEAD STONEFLY CABIN

Drawing inspiration from its farmstead surroundings, the 1,460-square-foot Stonefly Cabin combines rustic styling with consummate details. This two-bedroom, two-bath retreat is located near Tributary's core amenities and features an open-concept layout with natural finishes, a cozy fireplace, and a modern kitchen. Sliding doors in the great room and both bedrooms lead to a spacious deck, creating a seamless connection to the outdoors for relaxed, mountain living.

CONTACT US

SPAIN SHORT
(208) 268-8947

DIRECTOR OF REAL ESTATE
SSHORT@TRIBUTARYIDAHO.COM



EXPLORE MORE ONLINE
[TRIBUTARYIDAHO.COM/REAL-ESTATE](https://tributaryidaho.com/real-estate)



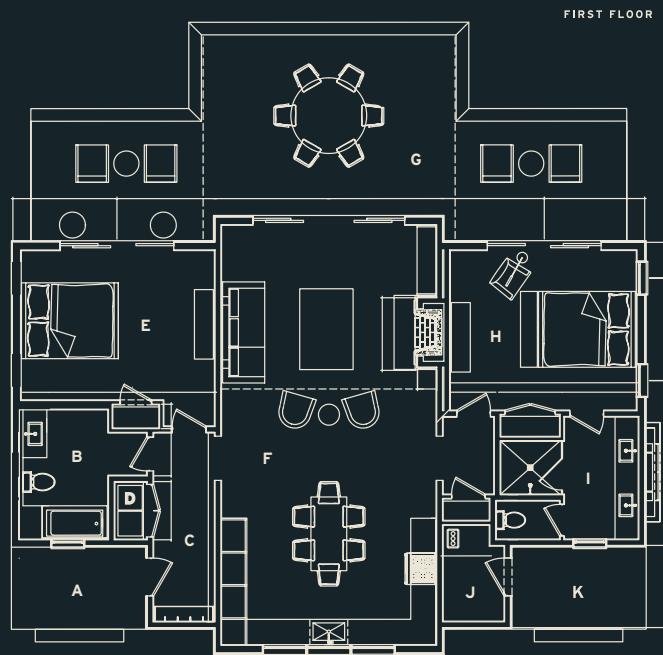

- A Entry Porch
- B Bathroom
- C Foyer
- D Laundry
- E Bedroom
- F Great Room
- G Deck
- H Primary Bedroom
- I Primary Bathroom
- J Mechanical/Utilities
- K Porch

STONEFLY CABIN

1,460 SQUARE FEET
2 BEDROOM, 2 BATH

TYPE

Single Family Residence

BEDROOMS & BATHROOMS

Bedrooms: 2
Full Bathrooms: 2

HEATING & COOLING

Electric in Floor
Central Air

PARKING

One Indoor Assigned Parking Space
with Owner Storage
6-Seat Golf Cart Included

FEATURES

Vaulted Ceilings
Fireplace
Large Covered Deck
Communal Ponds & Outdoor Firepits
Conveniently Located Near Clubhouse &
Core Amenities

MATERIALS

Marvin Windows
Trestlewood Barnwood Siding
Plastered Fireplace Wall
Interior Wood Paneling Details
Quartz Countertops
Monarch Hardwood Floors
Wolf/Subzero Kitchen Appliances
Asko Washer & Dryer
Moen Plumbing Fixtures & Appliances



Photos and images are representative only.
Interior and exterior finishes may differ and/or no longer be available.
Obtain the Property Report required by Federal law and read it before signing anything.
No Federal agency has judged the merits or value, if any, of this property.