



TRIBUTARY®



THE ULTIMATE ADVENTURE HOME BASECAMP CABIN

The nearly 5,000-square-foot Basecamp Cabin at Tributary was designed as the perfect launching point to greater Teton amenities. Offering a spacious two-level layout for relaxing and reliving the day's adventures, the Basecamp Cabin includes five bedroom suites, and a heated three-car attached garage. This inspired retreat challenges the expectations of what mountain real estate should be.

CONTACT US

SPAIN SHORT
(208) 268-8947

DIRECTOR OF REAL ESTATE
SSHORT@TRIBUTARYIDAHO.COM



EXPLORE MORE ONLINE
[TRIBUTARYIDAHO.COM/REAL-ESTATE](https://tributaryidaho.com/real-estate)



FIRST FLOOR

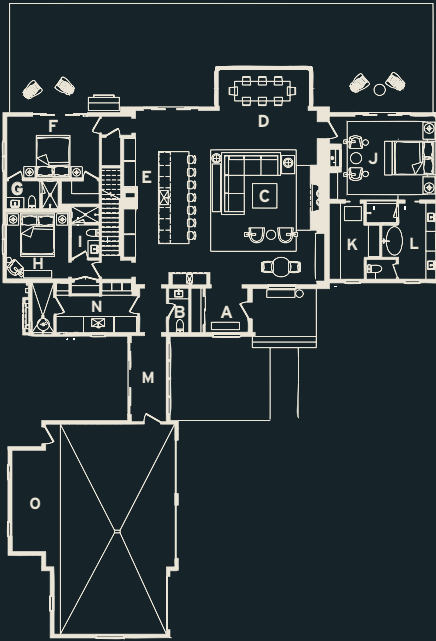

SECOND FLOOR

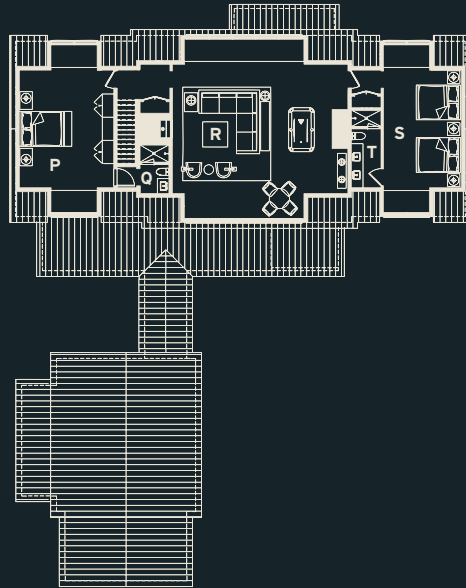

- A Entry
- B Bathroom
- C Great Room
- D Dining Bay
- E Kitchen
- F Bedroom
- G Bathroom
- H Bedroom
- I Bathroom
- J Primary Bedroom
- K Primary Closet
- L Primary Bathroom
- M Side Entry
- N Mudroom
- O Garage
- P Bedroom
- Q Bathroom
- R Media Room
- S Bedroom
- T Bathroom

BASECAMP CABIN

5,000 SQUARE FEET
5 BEDROOM, 5.5 BATH

TYPE

Single Family Residence

BEDROOMS & BATHROOMS

Bedrooms: 5

Full Bathrooms: 5

1/2 Bathrooms: 1

HEATING & COOLING

Electric in Floor

Central Air

PARKING

3 Car Heated Attached Garage

Epoxy Finish Floors with Drain

FEATURES

Reclaimed Wood Vaulted Ceilings

2 Wet Bars

3 Fireplaces

Large Second Floor Bonus Room

Large Deck & Outdoor Gas Fire Pit

MATERIALS

Interior & Exterior Stone Details

Wood Siding

Quartzite Countertops

Engineered Hardwood

Marvin Windows

Ashley Norton Hardware

Wolf/Subzero Kitchen Appliances

GE Washer & Dryer

Lutron Motorized & Manual Shades

Moen Plumbing Fixtures & Appliances



Photos and images are representative only.

Interior and exterior finishes may differ and/or no longer be available.

Obtain the Property Report required by Federal law and read it before signing anything.

No Federal agency has judged the merits or value, if any, of this property.